

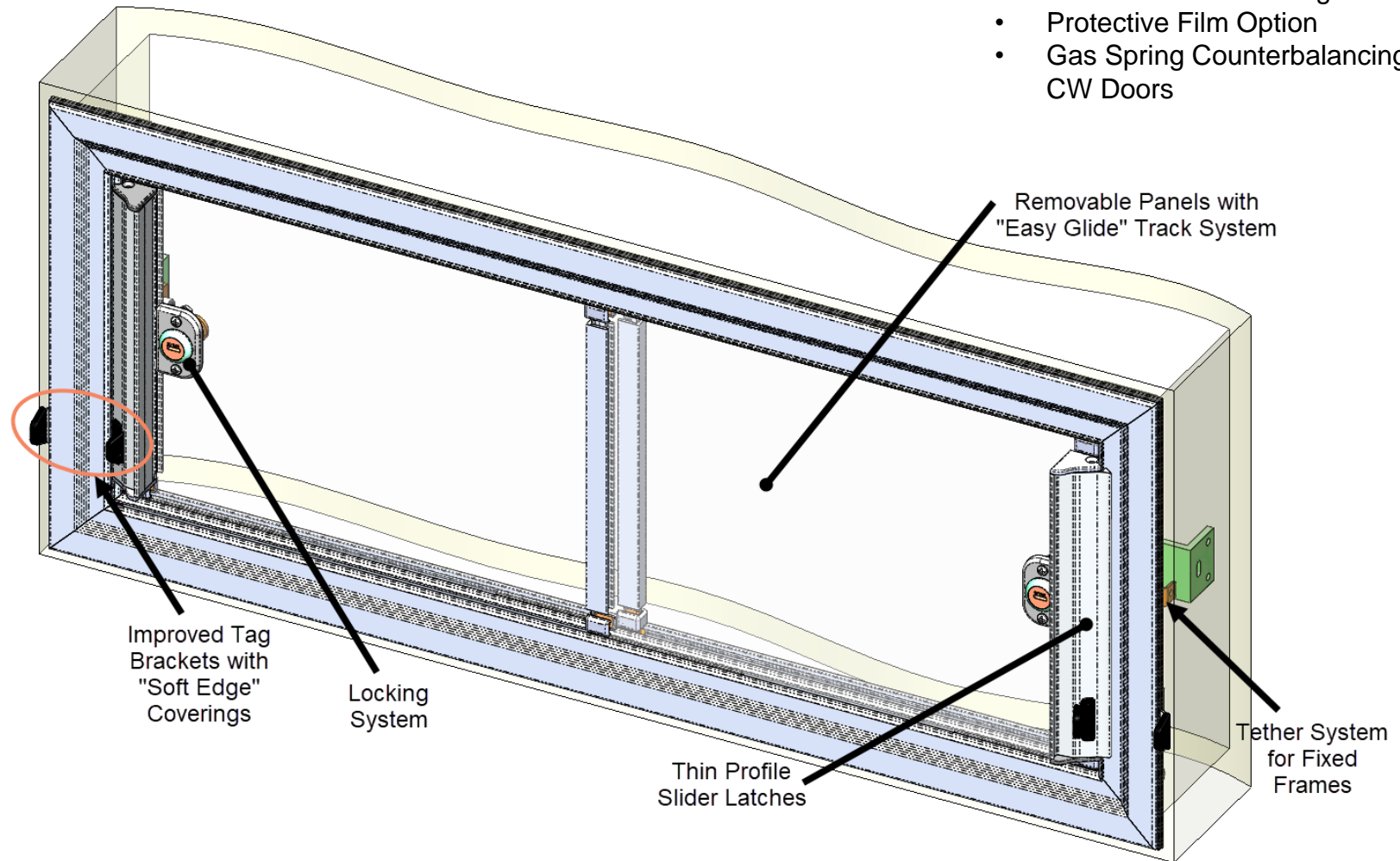

New Gen 3 Features Summary

Not Shown:

- New All Aluminum Hinges
- Protective Film Option
- Gas Spring Counterbalancing on CW Doors





LD Framed Family Gen 3 Improvements

Engineering Department

SlimLine Pinch Latch:

- Gives more than 1" extra access space than Gen 1 Latch
- Operates the same way as Gen 1 Slider Latch

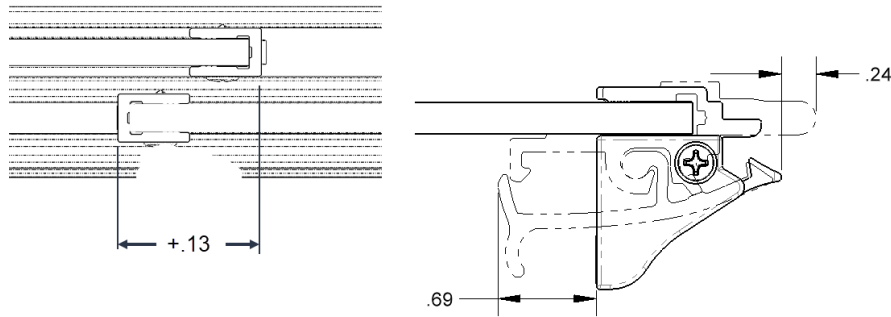

All Aluminum Hinge:

- 6061 aluminum anodized to match frame
- Replaceable after frame is assembled.
- New "3 Slotted" Shim for easier frame height adjustment after all three screws are installed.

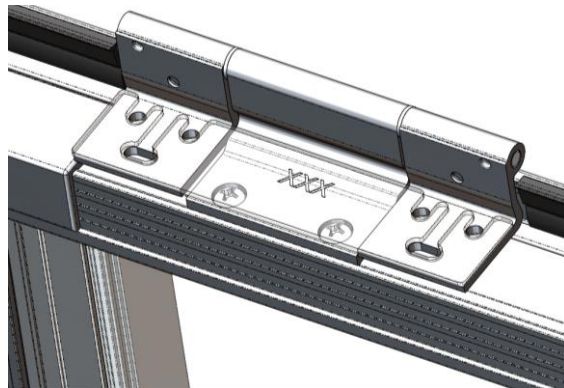

Removable Panels:

- "Easy Glide" Panel Guides replace full length flocking and provide smooth sliding action for all size panels.
- Panel can be removed/replaced by removing the four screws, moving Glides to ends of track, dropping panel into bottom track and tilting top out.
- Screws retain panel in track under impact load.

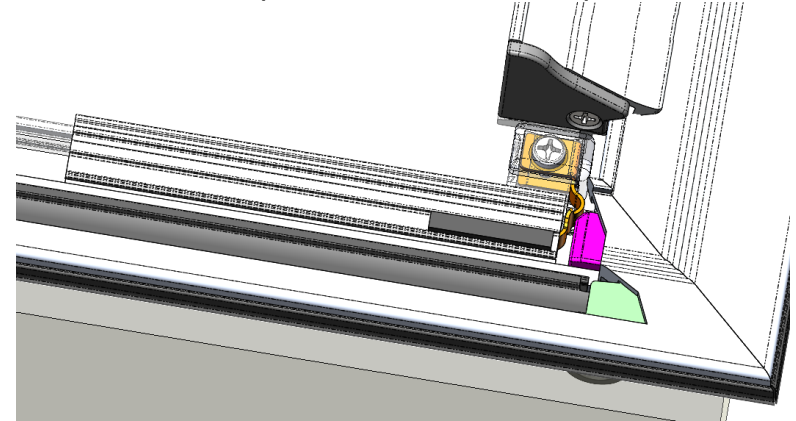

Protective Film Option:

- Can be left on frame through the manufacturing process or even through delivery, if desired.





LD Framed Family Gen 3 Improvements

Engineering Department

Tethers for Fixed Frames:

- Used IN ADDITION to the required FRAME CLIPS, these provide additional security for Fixed Frames.
- Designed to absorb energy and keep frame attached to cabinet in severe crash conditions where cabinet structure might break apart.
- Also prevents potential side-to-side sliding movement of frame in opening.

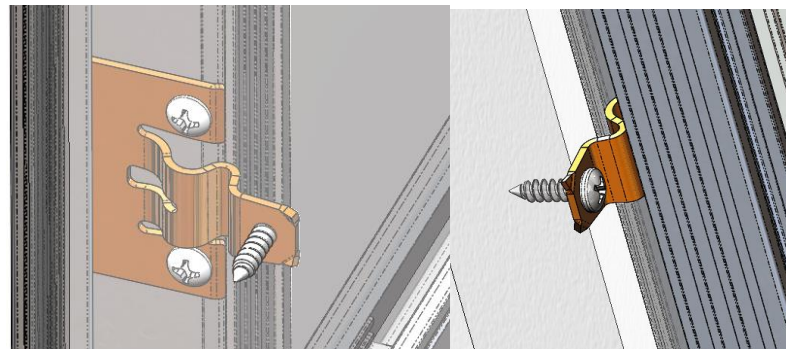

Locking System:

- Economically Locks Sliders/Restockers
- Locks Fixed Frames and Restocker Frames.

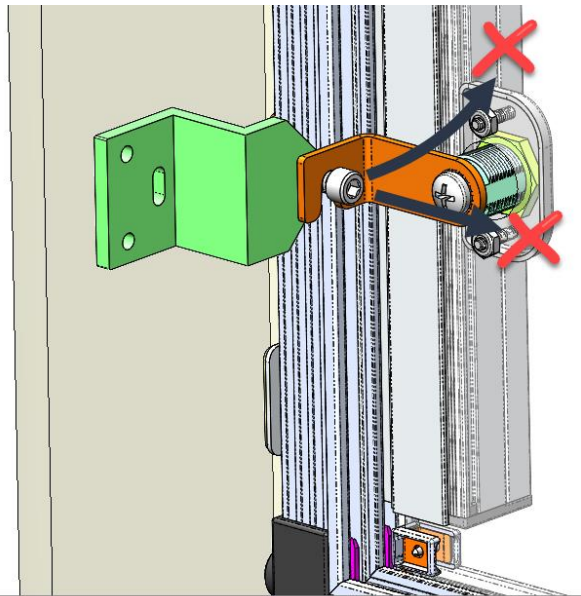

Improved Tag Brackets:

- Molded plastic covers encapsulate slot and eliminate all edges.
- Slots are closer together than Gen 1.
- Latch bracket attaches with Jig and two rivets

